

Digital Pressure Gauge XY-PG280G

Typical Feature

- Wireless Transmission GPRS/LORa/NB-iot options
- Stainless steel 304 shell, diameter 80mm
- 4-Digits LCD with white backlight
- Low power design, 24V power supply
- Accuracy level: Pressure 0.5%FS;
- Pressure range -0.1~0...0.01~0.1~1.6~10~160MPa











Brief Introduction

XY-PG280G Wireless Digital Pressure Gauge is low power consumption and with wireless output, wireless communication protocol is optional GPRS, LORa-iot, NB-iot. The high precision pressure sensor was built-in to display accurately in real time, at the same time it has high precision and long-term stability; stainless-steel shell and joint with good shock resistance, thus it is suitable to measure gas, liquid, oil and others medium without corrosion for stainless steel, especially for the work condition is hard to check pressure on site frequently.

These series digital pressure gauge is equipped with large-sized LCD display, it's easy to read data on site, at the same time upload record to cloud, upload rate is adjusted from 1 minute to 24 hours.

It's a real perfect Wireless Digital Pressure Gauge for Fire Water Pipe Network, Fire Alarm Station, Fire Pump Room, Water Supply, Petrochemical and others filed required Remote Monitoring. It is alternative for the system involved by Pressure Transmitter, Transmission Module and Power Distribution Box, consider its small size, convenient installation and cost-effective. They powered by 24VDC power supply.

Suggested Applications

-  Water Treatment System
-  Water Pump and Air Compressor
-  Electromechanical Equipment Automation
-  Engineering Machinery
-  Medical Equipment
-  Hydraulic and Pneumatic Systems
-  Laboratory
-  Customized Applications

[More details for XY-PG280G, please contact us.](#)

Specification

Model	XY-PG280G
General Pressure Range	0~0.2~0.6~1~2.5~10~25~40~60~100~160MPa
Micro-pressure Range	(0~5~10~25~40~60~100) KPa
Composite range	(-0.1~0~0.1~0.25~0.4~0.6~1~1.6~2.5) MPa (-10~10; -25~25; -40~40; -60~60; -100~100) KPa

Pressure Type	Gauge Pressure Test, Vacuum Pressure Test
Dimension	Φ80mm; Thickness 48mm
Overload Capacity	150% (>10MPa); 200% (≤10MPa)
Measurement Medium	Gas or Liquid with Compatibility of SS 316
Accuracy Level	0.2%FS;0.4%FS;0.5%FS;
Long-Term Stability/Year	Typical: ±0.2% FS
Operation Temperature	-20 ~ 70°C; -20_150°C is customized
Compensation Temperature	0 ~ 60°C
Working Humidity	<85%
Display	4 digits LCD, white backlit display
Alarm Point Set	High & Low alarm points can be set within range
Power Supply	24VDC, 220VAC are optional

Dimension(mm)

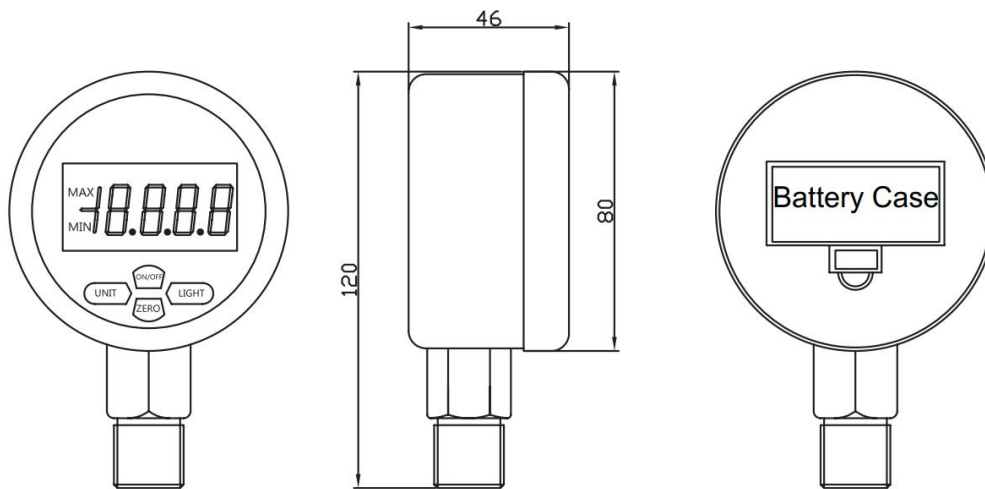

Mechanical Connection(mm)

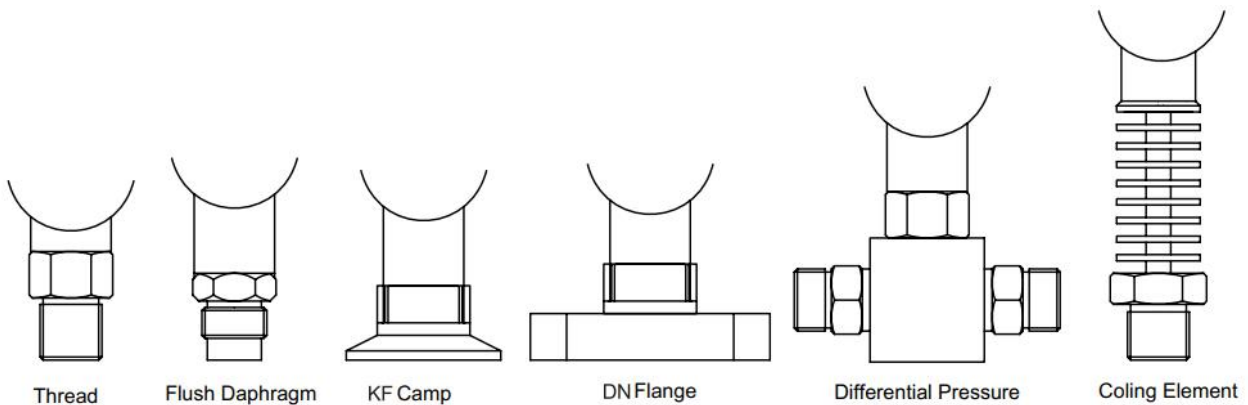

How To Order

XY	PG	280	E	P	60M	1	P2	J	M3	B1	T1	L	
	Category	Type	Setup	Pressure Connection	Pressure Range	Accuracy	Power	Output	Thread	Electrical Connection	Medium Temperature	Additional	
PG	Pressure Gauge	280 High Accuracy	E Lower Mount	None General Thread	1K (0-10Pa)	1 0.40%	P0 Battery	R RS485	M1 M20*1.5	B Cable Outlet	T1 -5~40°C	LC LCD Display	
		210 High Accuracy Pressure&Temperature	Z Panel Mount	P Diaphragm Seals	1B (0-1Bar)	2 0.20%	P2 24V	A 4-20mA	M2 G1/4	C Circular Connector	T2 -20~80°C	LE LED Display	
		270 Explosion-Proof	G Wireless	DP Differential Pressure	1M (0-1MPa)	3 0.10%	P4 120V	J1 Relay	M3 G1/2	CC Customized	T3 Customized	TI Explosion-Proof	
		280 80mm Dial Size LCD Display	F Peak Record	VF Clamp	OC Customized	4 0.50%	P5 280V	J2 Dual Relay	M4 1/20PT				
		260 60mm Dial Size	V Vacuum Switch	DN Flange		5 0.25%	P6 12V	CC Customized	M5 1/40PT				
		380 100mm Dial Size	W Water Pump Switch	9999 Customized		9 Customized	P9 Customized		M7 G3/4				
		380 80mm Dial Size LED Display							M9 Customized				
		360 Digital Remote Transmission											
		825 Contact 60mm Dial Size											
		825 Contact 80mm Dial Size											
PS	Pressure Switch	630 60mm Dial Size											
		828 80mm Dial Size											
		928 100mm Dial Size											
		650 Switch Box with Plastic Shell											
		660 Switch Box with Full Metal Shell											
PC	Pressure Control	680 60mm Dial Size											
		880 80mm Dial Size											
		980 100mm Dial Size											

Remark 1. This form is for whole Pressure Measurement and Pressure Control products, please read Product Date Sheet to get reference informations
2. If you may not find right information in this form, Please contact us to get future details

Shanghai XuYan Precision Technology Co., Ltd.

Address: No. 969, YunHan Road Pudong District Shanghai City China

Tel: +86 21 59241315

Email: sales@xvyanprecision.com

Website: www.xvyanprecision.com

Product Manager: Tyler Tou

Cell: +86 189 1797 0680

Email: ttao@Xuyanpercision.com